

Palmview Post

Contact us

31 College Drive
Palmview QLD 4553
Student Absence – 5231 5666

Email – admin@palmviewss.eq.edu.au
Phone – 5231 5222
Uniform Shop – 5231 5202

Dates to Remember

Harmony Day – Wear Orange and raise funds for our student council 21 March	PLC Cross Country 24 March
Easter Hat Parade 9.15am 28 March	PBL Celebration Day 30 March
P&C Colour Run 12pm – 3pm 31 March	First Day Term 2 17 April
ANZAC Day Ceremony 11am – 12pm 24 April	ANZAC Day Public Holiday 25 April
Labor Day Public Holiday 1 May	Sydney Canberra Year 6 Camp 12 – 16 June
Junior Athletics Carnival 9am – 1pm 19 June	Senior Athletics Carnival 21 June
PBL Celebration Day 22 June	Under 8's Day 23 June

From the Principal

Term 1 Learning

Our students and teachers have engaged positively in Term 1 learning and teaching tasks. Parent/Teacher interviews are occurring at this point in time to enable parents to be informed of their child's progress so far in the year.

Head of Inclusion

The state-wide merit process for the Head of Inclusion position at Palmview SPS through to the end of the year has been completed. We wish to congratulate Caroline Kelly as the successful applicant.

Scan and Assess – Intentionally Inviting Environment: Our school has a Pedagogical Pledge. This pledge guides the way our teaching staff facilitate learning and teaching opportunities. One of the components of our pledge is the creation of an "intentionally inviting environment." For the remainder of this term and early next term, we will be investigating how we are going in relation to the implementation of this aspect of our pledge. To do this, we will be talking with students, staff and parents to gain their perceptions. In their student leadership roles as eLearning Captain and Cultural Captain respectively, Aisha O'Donnell (6B) and Kyla Schumacher (6B) will soon conduct brief interviews as part of this process. iMovie interviews will be conducted with a random sample of students, staff and parents. Some interviews will occur before school, some at break times and some during school hours. Please be supportive of this process should these student leaders approach you.

Palmview Post

Facility Update

From the beginning of Term 2 our Year 4 to 6 students will be moving to our new block – F Block. Recently, we were able to tour our new 10 classroom block, as it nears the end of the construction period. This new block will be a welcome asset to our school and features a custom-designed playground especially suited to senior primary students at the oval end of the block. The diagram below shows where are senior classes will be located post Easter.

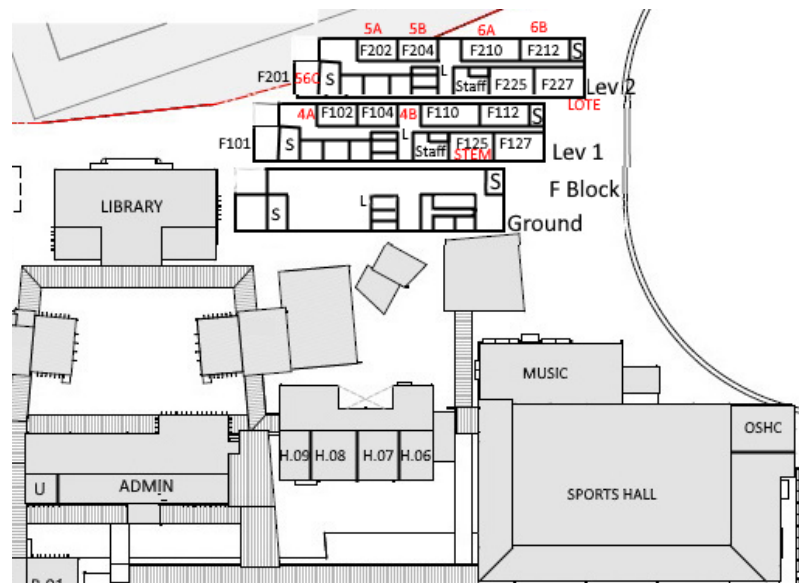

Volunteer Program

Palmview SPS encourages volunteers to assist within our educational programs. This year we will be seeking volunteers for

- Library book preparation and placement
- Stephanie Alexander Kitchen
- Stephanie Alexander Garden
- Classroom reading programs

Over the coming weeks we may add additional programs to our volunteer program.

In order to volunteer in all areas across the school we recommend that all volunteers apply for a volunteer blue card. The department Blue Card requirements changed in 2020 and all volunteers require a physical copy of your active Blue Card before you can start volunteering across the school site. Blue Cards can be applied via Blue Card Services <https://my.bluecard.qld.gov.au/>



Palmview SPS will be hosting a Volunteer Induction Sessions across the term. To find out more information please contact the office on 5231 5222

Palmview Post

From the Business Manager



Student Resource Scheme

Thank you to those who have made SRS first instalment payments that were due at the beginning of this term. Second instalments will be due by 28 April and final instalments will be due 21 July. If you have not paid for your SRS in part or full and have not contacted the office to arrange for a payment plan please do so now.



We are committed to ensuring that every student has the resources they need to succeed at Palmview – the SRS or the provision of stationery items from home is aligned with these successes.

Payment options available to parents – Bpoint, EFT, Bank Transfer, QKR, QParents, Centrepay – please see admin if you require any assistance with these payment options.



Qparents

Qparents is in use and we are seeing a number of families putting this app to use. QParents allows parents to update details including electronic permissions for excursions/incursions, address and contact phone numbers, view report cards electronically once they are confirmed in the system, alert us of absences and view/pay for any invoices that are registered with your student. If you would like some assistance in connecting to QParents please contact the office.

Attendance Matters!



Every Student, Every School, Every Day

Notification of Absence

Our school has a designated student absentee phone number – 5432 5666. We request that any absences are notified via this phone number prior to the start of the school day. Any absences that we have not had prior notification of will be notified to the residential parent/guardian by text message before 10am. If you receive a text message please reply to the message indicating the reason for absence, we will then update this in our system. You can also email the school to notify of your students absence - studentabsence@palmviewss.eq.edu.au



Palmview
State Primary School



Queensland
Government

Palmview Post

Late Arrivals

We ask that any student who arrives late is escorted to the administration office to be signed in. At this point students will receive a late pass that can be handed to the teacher on their arrival to class. Following this process will ensure that parents will not receive an absentee text message for late arrivals.

Early Leaves

If your student is required to leave early for the day we ask the following steps are to be undertaken

- Call the office to notify us of the need to leave early
- The office will generate an early leave request and will ensure the message is given to the classroom teacher to have your student waiting in administration on your arrival.
Please note – at times with short notice it is not always possible to have your child in the administration building on your arrival and a short wait may be required while we contact your student’s classroom. We will do our best to work with your requests where possible.
- We encourage parents to make appointments outside of school hours where possible to maximise your students educational experience at Palmview SPS.

College Drive / Drop Off and Pickup / Parking

We are continuing to listen to feedback and would like to remind parents of some changes made in Term 4 2022 to increase student safety and make our afternoon pick up go as smoothly as possible.

Thus far we have asked all parents to move their cars as far to the end of the pickup zone (Special School end of the zone) as possible and students are to enter cars at that end of the pickup zone. We are still seeing a number of students enter cars closer to the Administration/Crossing area of the pickup zone which can create an unsafe environment for students, parents and staff.

In Term 4 we trialled the following - all students who are due to be collected in the pickup zone will be required to exit the school from the front gates nearest the Hall (where our seating and new covered area is). This has seen some success and we will continue to operate our Pickup Zone in this way for the 2023 school year.

This will promote two-minute zone students moving to the Special School end of our pickup zone for collection by parents and split up the student’s exiting the school grounds by scooter/bike or pedestrian to create a safer flow through the front of the school.

Students who are accessing the bike racks, heading to the bus stop or using the zebra crossing to meet parents in cars will continue to use the main gates.

Just a reminder on our safety expectations If you are intending to use the drop off/ pick up lanes the following guidelines have been put in place to make this process as smooth and stress free as possible ☺

- Your student will be asked to wait in the tabled area beside Admin “Waiting Zone” / line up safely where a staff member will keep an eye on your student.
- We ask that all parents pull forward to the Special School end of the pick-up lane where a staff member will then deliver your student to your car.
- All students will be required to enter the car from the passenger side.
- Once your student is safely in your car you will be able to pull forward and the next car will then move to the end of the line to receive their student.

Palmview Post

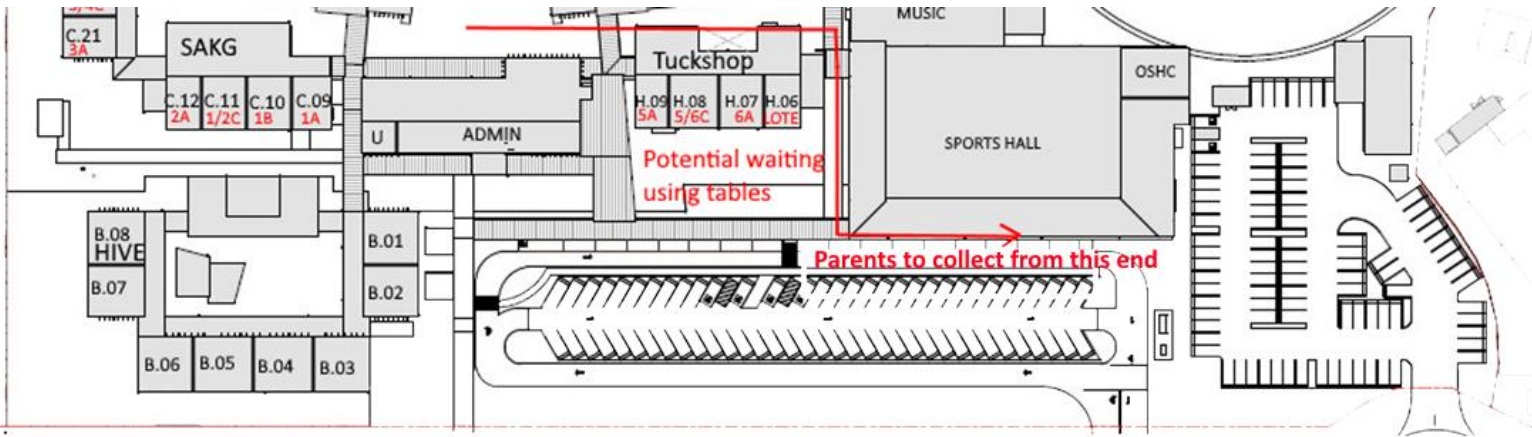

If you have any questions regarding this process please contact the office.

We appreciate your support in ensuring all students have a safe and welcoming environment at Palmview Primary from drop off to pick up every day.

From the YMCA OSHC Team

Here at Palmview OSHC we take pride in our professional practice to advocate for children's holistic development, focusing on the key principles of the YMCA: **MIND, BODY and SPIRIT**. We nurture children's leisure and play experiences by offering adventure programs, risky play themes, skills development and open-ended resourcing. Children will always be supported to be capable and competent and make decisions that are important to them.



Palmview Post

If you would like to enrol, please follow these steps or contact Lara at apv@ymcabrisbane.org for more information.

BSC 6am – 9am ASC- 3pm-6pm VAC & PP 6am-6pm

Go to <https://www.ymcabrisbane.org/>

- Find childcare
- Find OSHC care
- Find Sunshine coast
- Find Palmview
- Scroll to bottom and register in My Family Lounge
-

Check us out on Facebook - <https://www.facebook.com/YMCApalmviewOSHC>



Palmview
State Primary School



Queensland
Government